

# Available for Lease

## 479 Thomas Jones Way

### Oaklands Corporate Center

Exton, Pennsylvania



**GRUBB & ELLIS.**  
From Insight to Results

Office Group



## Aggressive New Ownership

- 18,250 RSF Available Immediately
- Divisible to 3,033 RSF
- Strategically located in Exton, PA, the center of the rapidly growing Chester County
- Easy access to Route 202, PA Turnpike and Route 100
- Shopping center, supermarket, banking facilities, daycare and restaurants on-site

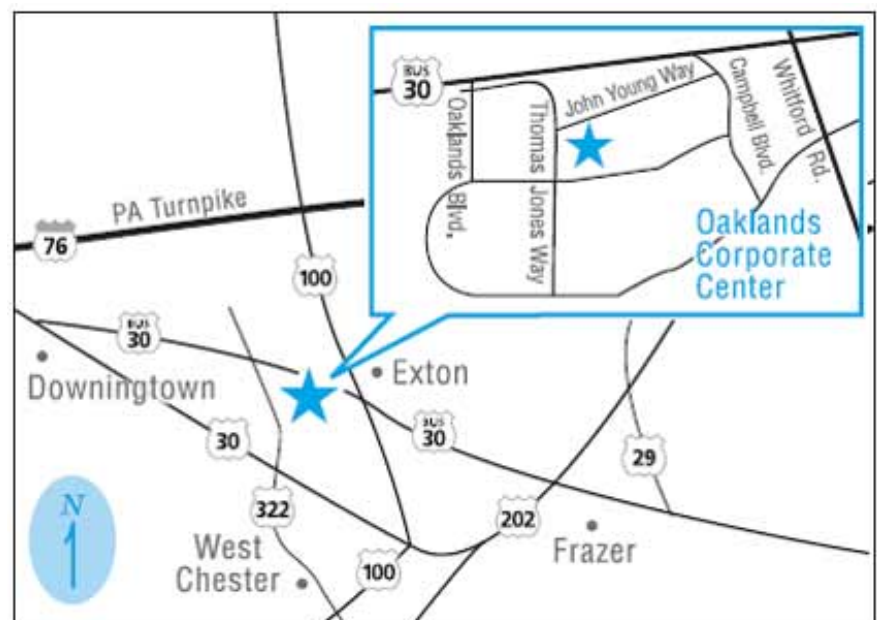

# Available for Lease

## 479 Thomas Jones Way

### Oaklands Corporate Center

Exton, Pennsylvania



**GRUBB & ELLIS.**  
From Insight to Results

Office Group

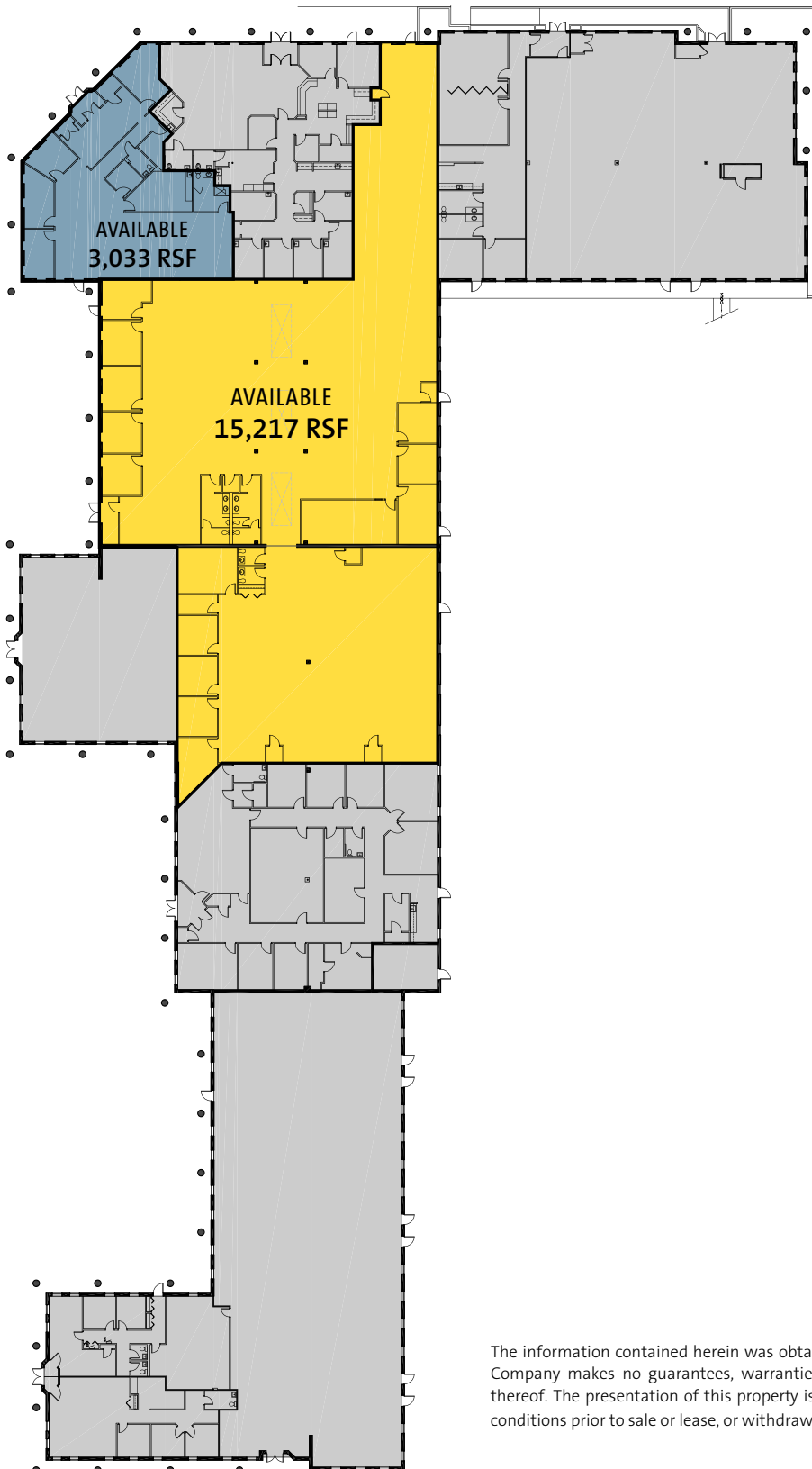

To learn more, please contact:

Grubb & Ellis Company  
1000 Continental Drive  
Suite 200  
King of Prussia, PA 19406  
610.337.1010 main  
610.337.1616 fax  
[www.grubb-ellis.com](http://www.grubb-ellis.com)

**James R. Dugan**  
Senior Vice President  
610.879.4513  
[james.dugan@grubb.ellis.com](mailto:james.dugan@grubb.ellis.com)

**Elaine Battaglia**  
Associate  
610.879.4514  
[elaine.battaglia@grubb-ellis.com](mailto:elaine.battaglia@grubb-ellis.com)



[www.dunntwigg.com](http://www.dunntwigg.com)

The information contained herein was obtained from sources believed reliable, however, Grubb & Ellis Company makes no guarantees, warranties, or representations as to the completeness or accuracy thereof. The presentation of this property is submitted subject to errors, omissions, change of price or conditions prior to sale or lease, or withdrawal without notice.